

3E ECSB Entrepreneurship Education Conference 2019

Program Summary

| | | |
|-----------------------------|---|---|
| Tuesday 7 May 2019 | | Chalmers University of Technology |
| 18:30–21:00 | Arrival Mingle Event – Wine and Canapés | Veras Lawn, Chalmers School of Entrepreneurship, Vasa Buildings |
| Wednesday 8 May 2019 | Practitioner Development Day | Lindholmen Conference Center |
| 8:30–9:00 | Registration | Central Hall |
| 9:00–9:25 | Opening and PDW Welcome | Pascal |
| 9:30–10:15 | Parallel Practitioner Development Workshops | Pascal, Tesla, Kelvin, Newton |
| 10:15–10:45 | <i>Fika – Swedish coffee break</i> | Central Hall |
| 10:45–12:10 | Parallel Practitioner Development Workshops | Pascal, Tesla, Kelvin, Newton |
| 12:15–13:15 | <i>Lunch</i> | Central Hall |
| 13:15–13:55 | Entrepreneurial Bridging | Pascal |
| 14:00–14:45 | Parallel Practitioner Development Workshops | Pascal, Tesla, Kelvin |
| 14:45–15:00 | <i>Fika – Swedish coffee break</i> | Central Hall |
| 15:05–16:30 | Parallel Practitioner Development Workshops | Pascal, Tesla, Kelvin, Coulomb |
| 18:30–21:00 | Welcome Reception and Best PDW Award - Wine and Standing Dinner Plate | Chalmerska Huset, Södra Hamngatan 11 |

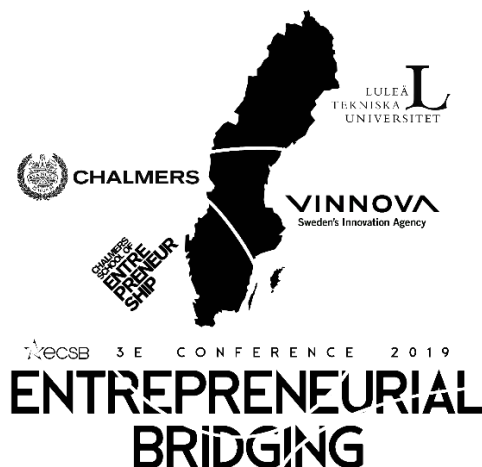

| Thursday 9 May 2019 | | Lindholmen Conference Center |
|----------------------------|--|---|
| 8:30–9:00 | Registration/info desk open | Central Hall |
| 9:00–9:30 | Opening & Conference Welcome | Pascal |
| 9:30–10:15 | Plenary 1: Kolb Interrupted: A phenomenographic study of experiential learning in entrepreneurship education | Pascal |
| 10:15–10:30 | <i>Fika – Swedish coffee break</i> | Central Hall |
| 10:35–12:00 | Parallel Paper Sessions | Pascal, Tesla, Kelvin, Aktiviteten 2, Aktiviteten 3 |
| 12:00–13:00 | <i>Lunch</i> | Central Hall |
| 13:00–14:25 | Parallel Paper Sessions | Pascal, Tesla, Kelvin, Aktiviteten 2, Aktiviteten 3 |
| 14:25–14:40 | <i>Fika – Swedish coffee break</i> | Central Hall |
| 14:45–15:25 | Parallel Paper Sessions | Pascal, Tesla, Kelvin, Aktiviteten 2, Aktiviteten 3 |
| 15:30–16:15 | Plenary 2: Triggering Identity Play in Entrepreneurship Education through Game-Based Learning | Pascal |
| 16:15–16:25 | Closing remarks | Pascal |
| 17:35 | Meet at Stenpiren for Tram (time critical) | Stenpiren tram stop |
| 18:30–23:00 | Conference Dinner – 3 course dinner (food served approx. 20:00) | Universeum (Korsvägen tram stop) |

| Friday 10 May 2019 | | Lindholmen Conference Center |
|---------------------------|--|--------------------------------------|
| 9:15–9:55 | Plenary 3: Classless Entrepreneurship Education? How social origins predict individual entrepreneurial orientation | Pascal |
| 10:00–10:15 | <i>Fika – Swedish coffee break</i> | Central Hall |
| 10:20–11:45 | Parallel Paper Sessions | Pascal, Tesla, Kelvin, Aktiviteten 3 |
| 11:45–12:45 | <i>Lunch</i> | Central hall |
| 12:50–14:15 | Parallel Paper Sessions | Pascal, Tesla, Kelvin, Aktiviteten 3 |
| 14:15–14:45 | Conference Closing Remarks and Announcement of 3E 2020 | Pascal |



Detailed Program

Wednesday 8th May: Practitioner Development Workshop (PDW) Program

| Rooms | Pascal | Tesla | Kelvin | Newton |
|-------------------------------|---|---|--|--|
| 08:30 - 09:00 | Registration | | | |
| 09:00 - 09:30 | Opening & PDW Welcome (Pascal) | | | |
| PDW 1 09:35 - 10:15 | <i>Values, ethics and critiques of entrepreneurship education</i> Entrepreneurial responsibility: A dilemma for entrepreneurial education Gustav Hägg, Ulla Hytti and Caroline Wigren-Kristoferson Chair: Per Blenker | <i>Online and blended-learning approaches</i> Giving voice to the invisible workforce: Reflections on the delivery of a small firm employee network capability development programme Felicity Kelliher, Deirdre Fleming, Leana Reinl and Una Grant Chair: Ulrika Persson-Fischier | <i>Student incubator initiatives</i> Grow your Business Birgitte Nielsen and Peter Errboe Jensen Chair: Malene Hangaard Alstrup | <i>Learning philosophies in entrepreneurship education</i> Writing a case study as part of a student internship: Bridging entrepreneurship theory and practice with academic learning goals Peter O. van der Meer Chair: Robert Malach |
| | <i>Fika – Swedish Coffee Break</i> | | | |
| PDW 2 10:45 - 11:25 | <i>Entrepreneurship education policy</i> Impact Entrepreneurship Competence - Reflective action towards sustainability? Mats Lundqvist and Lena Holmberg Chair: Gustav Hägg | <i>Entrepreneurship education for non-business students</i> She did it - I could do it too Rikke Johannesen and Rikke Lund Ehrenreich Chair: Kaija Arhio | <i>Student incubator initiatives</i> 27 hours a Day. A dual career course. Sebastian Landgren, Hanne Duedahl Nørgaard, Jette Jul and Malene Hangaard Alstrup Chair: Olga Belousova | <i>Pedagogical theories in entrepreneurship education</i> The Family Business Canvas: A Cultural Probe Tool For Family Business Education and Intervention Ed Gonsalves, Anette Lundebye and Rebecca Fakoussa Chair: Peter O. van der Meer |
| | <i>Engagement, impact and evaluation</i> Sustainable Entrepreneurship Education - SDGs as inspiration for entrepreneurship education Bart van Grevenhof and Ingrid Wakkee Chair: Mats Lundqvist | <i>Entrepreneurship education for non-business students</i> Educator - May the FORSE be with you! Developing a Framework for Organizing Studies Entrepreneurially Mats Westerberg, Karine Oganisjana and Lenita Hietanen Chair: Rikke Johannesen | <i>Student incubator initiatives</i> NON-Business students got talent Peter Errboe Jensen and Birgitte Woge Nielsen Chair: Sebastian Landgren | <i>Pedagogical theories in entrepreneurship education</i> Transforming Foundational Concepts into Applied Entrepreneurial Knowledge Sandra Malach and Robert Malach Chair: Nigel Adams |
| PDW 3 11:30 - 12:10 | | | | |

| Rooms | Pascal | Tesla | Kelvin | Coulomb |
|-------------------------------|--|--|--|--|
| 12:15 - 13:15 | <i>Lunch</i> | | | |
| 13:15 - 13:55 | Entrepreneurial Bridging (Pascal) | | | |
| PDW 4 14:00 - 14:40 | <i>Entrepreneurship education policy</i> We Need To Talk About... [Entrepreneurship Education and Public Policy] Per Blenker, Catherine Brentnall and Martin Lackéus Chair: Niels Bosma | <i>Learning philosophies in entrepreneurship education</i> Learning from an entrepreneur through a reflective journey Juan Francisco Alvarado Valenzuela and Jeanne Martens Chair: Rebecca Fakoussa | <i>Online and blended-learning approaches</i> Developing intercultural competences for entrepreneurship among students in Europe and Latin America through virtual exchange Olga Belousova, Ulrika Persson-Fischier, Marina Melan, et al. Chair: Felicity Kelliher |  |
| | <i>Fika – Swedish Coffee Break</i> | | | |
| PDW 5 15:05 - 15:45 | <i>Entrepreneurship education policy</i> Enterprise & Entrepreneurship Education Evaluation - A Realist Approach Philip Clegg and Catherine Brentnall Chair: Martin Lackéus | <i>Learning philosophies in entrepreneurship education</i> The Use of Narratives in Entrepreneurship Education: Crowdfunding Campaigns as a Learning Vehicle Christian Greiner and Tom Peisl Chair: Jeanne Martens | <i>Pedagogical theories in entrepreneurship education</i> An experimental approach in continuing education Christina Højlund, Birgitte Helbæk Marcussen and Agnete Gudnason Chair: Kaarin Kivimäki | |
| | PDW 6 15:50 - 16:30 | <i>Entrepreneurial Universities</i> Towards an entrepreneurial university - Challenges and directions for non-technical universities Niels Bosma and Jelle Kok Chair: Karen Williams Middleton | <i>Pedagogical theories in entrepreneurship education</i> Entrepreneurship education - misunderstanding the goals? Kaija Arhio, Leena Eskola and Marja-Liisa Kaakko Chair: Tom Peisl | <i>Pedagogical theories in entrepreneurship education</i> The Entrepreneurial Educator's "Polyphonic" Classroom David Higgins Chair: Sandra Malach |
| 18:30 – 21:00 | | Welcome Reception and PDW Awards – Chalmerska Huset | | |

Thursday 9th May Conference Program

| <i>Rooms</i> | Pascal | Tesla | Kelvin | Activiteten 2 | Activiteten 3 |
|-----------------------------------|---|---|---|--|---|
| 08:30 - 09:00 | Registration | | | | |
| 09:00 - 09:30 | Welcome & Opening Remarks (Pascal) | | | | |
| 09:30 - 10:15 | Plenary 1: Kolb Interrupted: A phenomenographic study of experiential learning in entrepreneurship education (room: Pascal) Jonathan Marks Chair: Helle Neergaard | | | | |
| 10:15 - 10:30 | <i>Fika – Swedish Coffee Break</i> | | | | |
| | <i>Foundations</i> | <i>Entrepreneurial Pedagogy</i> | <i>Contextual Learning</i> | <i>Entrepreneurial Mindset</i> | <i>Value Creation</i> |
| Session 1 10:35 - 11:15 | The Philosophical Foundations of Entrepreneurship Education Catherine Brentnall and David Higgins Chair: Per Blenker | The entrepreneurial diary – A method to enhance student entrepreneurs reflective thinking abilities in experiential entrepreneurship education Gustav Hägg Chair: Oskar H. Svensson | Tacit Knowledge and Implicitness in Entrepreneurial Learning Settings Michael Breum Ramsgaard and Karen Heide Hauge Andersen Chair: Even Larsen | The Development of an Entrepreneurial Mindset - A Systematic Literature Review Kari Djupdal, Iselin Kristine Mauseth, Karin Wigger and Karolina Lesniak Chair: Mats Westerberg | Unintentional Exposure to Entrepreneurial Behavior and Value Creation Pekka Stenholm, Riikka Franzén, Lenita Nieminen and Joachim Ramström Chair: Judit Bragelien |
| Session 2 11:20 - 12:00 | Emancipating the 'Who am I?' Question in Entrepreneurship Martin Lackéus, Mats Lundqvist and Karen Williams Middleton Chair: Ulla Hytti | Vicarious Learning from Entrepreneurial Failure Ingrid Wakkee, Jeanne Martens and Juan Francisco Alvarado Chair: Gustav Hägg | Contextual Resources and Entrepreneurship Education – A Source to Competitive Differentiation? Torgeir Aadland Chair: Karen HH Andersen | Measuring Entrepreneurial Mindset: Developing implicit and situated Measures to assess Entrepreneurial Growth Mindset Steffen Weyreter, Stephan Lengsfeld and Tino Endres Chair: Iselin K. Mauseth | Integration of Entrepreneurial Education as Value Creation into the Humanities Helle Meibom Færgemann, Sarah Robinson and Wesley Shumar Chair: Pekka Stenholm |
| 12:00 - 13:00 | Lunch | | | | |

| Rooms | Pascal | Tesla | Kelvin | Activiteten 2 | Activiteten 3 |
|-----------------------------------|---|---|--|--|---|
| | <i>Entrepreneurship Edu in Schools</i> | <i>Entrepreneurial Identity</i> | <i>Analysing Learning</i> | <i>Entrepreneurial Pedagogy</i> | <i>Sustainable Entrepreneurship</i> |
| Session 3 13.00 - 13:40 | Developing Entrepreneurial Skills in Compulsory Education - Initial Challenges with Which, How and Progression Karin Axelsson, Anna Haglund and Sara Hägglund Chair: M. Lindhal Thomassen | Learning to lead in the entrepreneurship education context Michael Breum Ramsgaard Chair: K. Williams Middleton | A Theory-Driven Meta-Analytical Framework for International Research on EE in HE Britta Gossel Chair: Cathrine Brentnall | A Hypothesis-Based Didactic in Entrepreneurship Education Helle Munkholm Davidsen and Christina Højlund Chair: Inger B. Pettersen | Educating for Sustainable Entrepreneurship: Leverage Points from the Literature Matthias Pepin, Maripier Tremblay and Luc Audebrand Chair: Helle M. Færgemann |
| Session 4 13:45 - 14:25 | Principals developing entrepreneurial culture in schools Minna Hämäläinen, Elena Ruskovaara and Timo Pihkala Chair: David Higgins | Entrepreneurial Prototypes: Identity Construction in Entrepreneurship Education Stephanie Raible and Karen Williams Middleton Chair: Claus Thrane | Making Sense of Entrepreneurial Knowledge in Recognition of Prior Learning and Studification Practices Kirsi Peura, Tarja Römer-Paakkanen & Satu Aaltonen Chair: Britta Gossel | Educating the Innovative and Entrepreneurial Individual in China Naja Morell Holm Hjortshøj Chair: Erwin Huang | Sustainable Entrepreneurship Education through Social Innovations, Digitalization and Collaboration Judith Bragelien Chair: Matthias Pepin |
| 14:25 - 14:40 | <i>Fika – Swedish Coffee Break</i> | | | | |
| Session 5 14:45 - 15:25 | The University's Role in Developing Entrepreneurial Ecosystems: Lessons Learned From 20 Years of Experience Steve Barr and Jeff Pollack Chair: Torgeir Aadland | Should entrepreneurship education focus on maximizing the amount of entrepreneurs? Ruud Koopman Chair: M. Breum Ramsgaard | Social Entrepreneurial Intention – Are we Behind the Curve? Lisa Murphy and Helen McGuirk Chair: Helle M. Davidsen | Playfulness - A Novel Approach to Learning About Family-Owned Business Dynamics Ed Gonsalves and Rebecca Fakoussa Chair: Noriko Taji |  |
| 15:30 - 16:15 | Plenary 2: Triggering Identity Play in Entrepreneurship Education through Game-Based Learning (room: Pascal) Claus Thrane & Rajiv. V. Basaiawmoit Chair: Breda Kenny | | | | |
| 16:15 - 16:25 | Closing Remarks (Pascal) | | | | |
| 17:35 | Meet at Stenpiren for Tram and Bridging event | | | | |
| 18:30 - 23:00 | Conference Dinner and Best Paper Award – Universeum | | | | |

Friday 10th May, Conference Program

| Rooms | Pascal | Tesla | Kelvin | Activiteten 3 |
|-----------------------------------|--|---|--|---|
| 09:15 - 09:55 | Plenary 3: Classless Entrepreneurship Education? How Social Origins Predict Individual Entrepreneurial Orientation (room: Pascal) Leif Brändle and Andreas Kuckertz Chair: Sally Jones | | | |
| 10:00 - 10:15 | <i>Fika – Swedish Coffee Break</i> | | | |
| | <i>Learning Cycles</i> | <i>Rhetoric</i> | <i>Student Driven Innovation</i> | <i>Assessing Competencies</i> |
| Session 6 10:20 - 11:00 | Experienced entrepreneurial learning and preferred learning styles Elma Van der lingen, Bjorn Willy Åmo and Inger Beate Pettersen Chair: Jonathan Marks | In the Eye of the Beholder - Exploring Entrepreneurship in Education with a Visual Rhetorical Lens Katarina Ellborg Chair: Lise Aaboen | Student-expert collaboration and the role of knowledge domains in developing technology-based new venture ideas Kari Kleine Chair: Catherine Heuch | What do we call “successful” entrepreneurial education? Towards a systemic model for the assessment of entrepreneurial competencies in the university setting Javier A. Rodriguez-Camacho Chair: Tomas Karlsson |
| Session 7 11:05 - 11:45 | Identify Hidden Curriculum in Experiential Entrepreneurship Education Through Student Reflections Even Larsen Chair: Bjorn Willy Åmo | Entrepreneurship- what are we talking about? - Gaps created by rhetorical challenges and misplaced foci Mette Lindahl Thomassen Chair: Katarina Ellborg | From making gadgets to making talents: Exploring the social dynamics in a student-driven makerspace Inger Beate Pettersen, Elin Kubberød, Axel Zeiner and Fredrik Vangsal Chair: Silke Tegtmeier | Validity Problems in Quantitative Studies on Entrepreneurial Competencies Erik O'Donnell Chair: Javier Rodriguez-Camacho |
| 11:45 - 12:45 | <i>Lunch</i> | | | |

| Rooms | Pascal | Tesla | Kelvin | Activiteten 3 |
|-----------------------------------|---|--|---|--|
| | <i>Experiential Learning</i> | <i>3 Day Workshops</i> | <i>Student Entrepreneurship</i> | <i>Assessing Entrepreneurship</i> |
| Session 8 12.50 - 13:30 | The Entrepreneurial Processes as Experiential Learning Tomas Karlsson and Mark Schenkel Chair: Elin Kubberød | Nursing Students Recognising Entrepreneurial Opportunities through a Three-Day Entrepreneurship Camp Gunn-Berit Sæter, Lise Aaboen and Diamanto Politis Chair: Lisa Murphy | Student Entrepreneurship: Developing Resources to Build Legitimacy Cathrine Heuch and Vilde Bergan Chair: Kari Djupdal | Social Media as an Assessment Tool in Undergraduate Entrepreneurship Education Erwin Huang, Derek Lam, Aki Leung and Beatrice Chu Chu Chair: Martin Lackéus |
| Session 9 13:35 - 14:15 | Struggling for Authenticity: a Dialectic Framework for Sense-Making Entrepreneurial Experiences Oskar Hagvall Svensson Chair: Kirsi Peura | The Effectiveness of Three-Day Entrepreneurship Programs in Japan: How Startup Weekend Influenced Entrepreneurial Self-Efficacy and Intention Noriko Taji, Tomas Karlsson, Hiromi Yamada, Shingo Igarashi, Yu Niiya and Lim Yeongjoo Chair: Steve Barr | The Importance of Time in a University Student Venture Incubator Lise Aaboen, Kari Djupdal, Torgeir Aadland, Dag Håkon Haneberg, Vetle Slagsvold Øien and Roger Sørheim Chair: Ruud Koopman | Assessing Entrepreneurship Education in Primary Schools in Hong Kong Erwin Huang, Aki Leung, Beatrice Chu, Derek Lam, Tsz Wing Chu and Bibian Wong Chair: Karin Axelsson |
| 14:15 - 14:45 | Conference Closing Remarks (Pascal) | | | |





CONTACT INFORMATION

Conference Chairs:

Chalmers

Mats Lundqvist

Mobile: +46 (0)703 088 017

Email: mats.lundqvist@chalmers.se

Karen Williams Middleton

Mobile: +46 (0)730 794 339

Email: karen.williams@chalmers.se

Luleå

Kaarin Kivimäki

Mobile: +46 (0)703 121 325

Email: Kaarin.Kivimaki@ltubusiness.se

Mats Westerberg

Mobile: +46 (0)706 569 981

Email: mats.westerberg@ltu.se

Chalmers Conference Support Staff:

Anna Tullsten

Mobile: +46 (0)31 772 8335

Email: anna.tullsten@chalmers.se

Anneli Hildenborg

Mobile: +46 (0)31 772 8246

Email: anneli.hildenborg@chalmers.se

ECSB:

Elisa Akola

Email: ecsb@utu.fi

CONFERENCE VENUES

Arrival Event – Tuesday 7th May:

Veras Lawn, Chalmers School of Entrepreneurship

Vera Sandbergs Alle, Chalmers University of Technology, Vasa Buildings
(Tram stop: Kapellplatsen)

Conference Venue (May 8th – 10th)

Lindholmen Conference Center

Address: Chalmers Konferens & Restauranger

Lindholmen Science Park, Lindholmospiren 5, 417 56 Göteborg
(Ferry stop: Lindholmospiren; Bus stop: Lindholms Allén)

Welcome Reception – Wednesday 8th May

Chalmerska Huset

Address: Södra Hamngatan 11, 411 14 Göteborg
(Tram stop: Stenpiren)

Conference Dinner – Thursday 9th May

Universeum

Address: Universeum, Södra Vägen 50, 400 20 Göteborg
(Tram stop: Korsvägen)

Conference Venues: Arrival Event, Lindholmen, Chalmerska Huset, Universeum

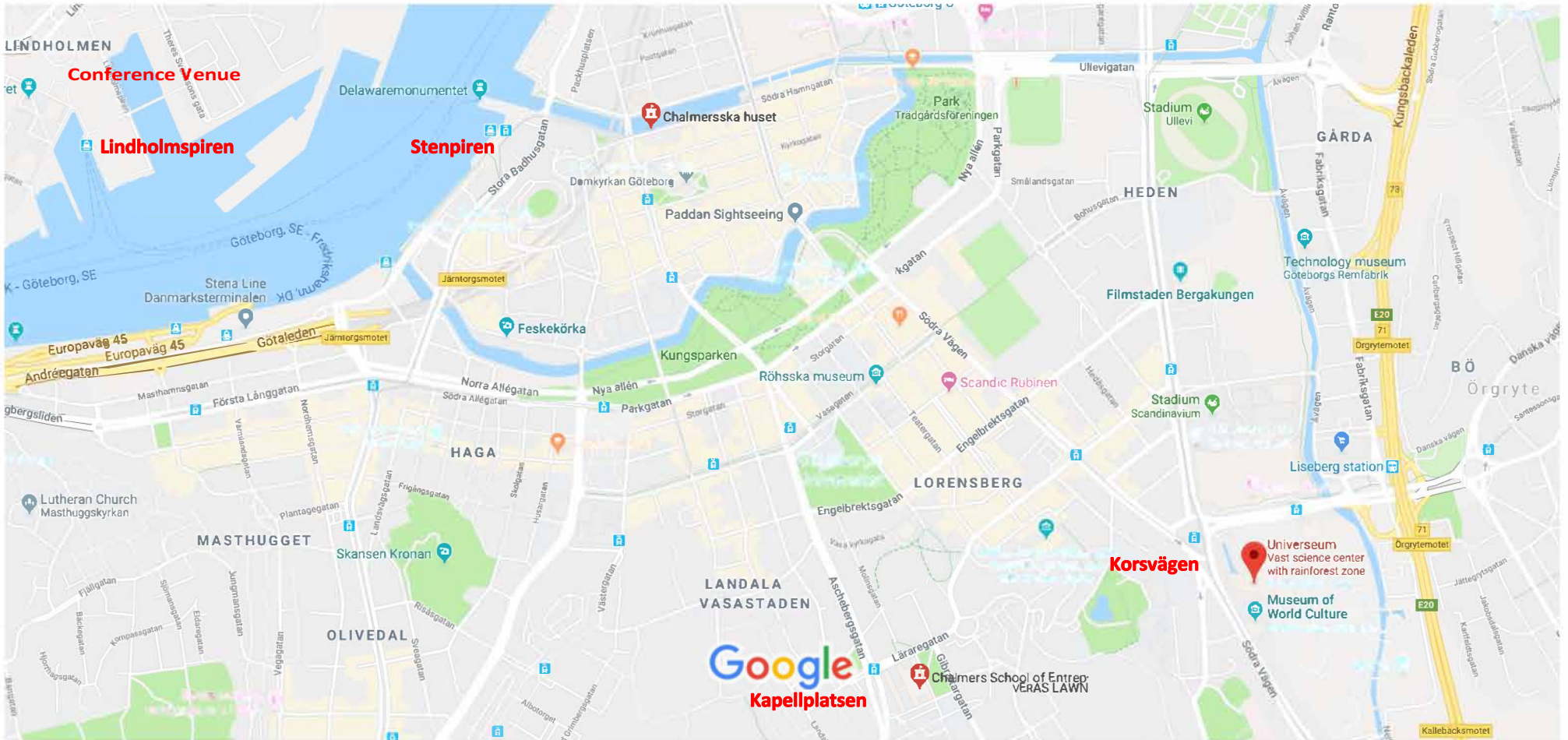

Map data ©2019 Google 200 m

Lindholmen Science Park Lindholmen Conference Centre

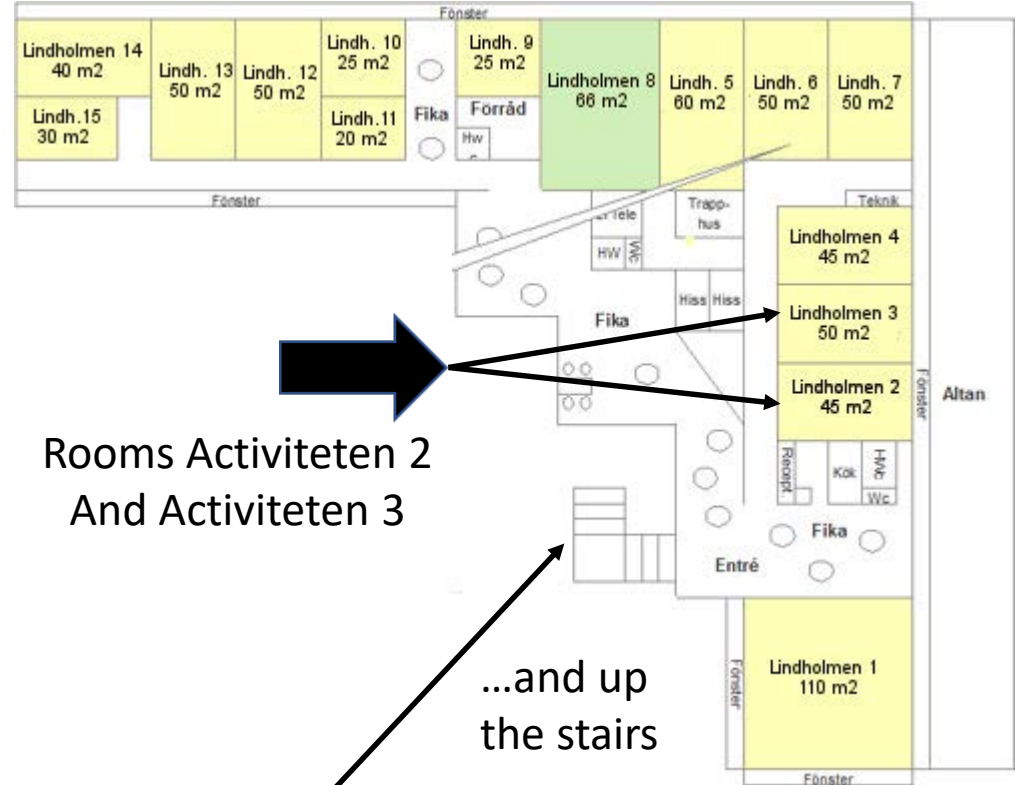
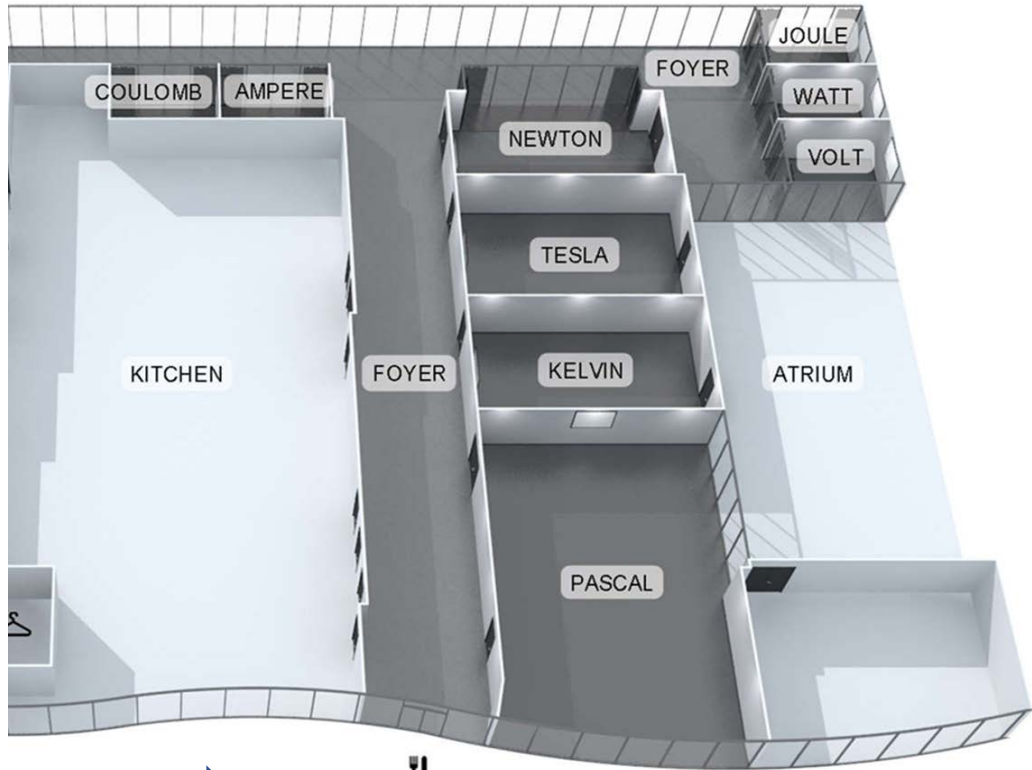

Rooms Activiteten 2
And Activiteten 3

...and up
the stairs

Entrance from the
bus stop Lindholms Allén

Entrance from
the Ferry stop
Lindholmospiren

To rooms Activiteten 2 and 3 through cafeteria area...